

# Hunnewell Elementary School Feasibility Study

SMMA  
**COMPASS**  
PROJECT MANAGEMENT



# Tentative Concept Plans





# Site Considerations



# Neutral to designs

- Educational Program
- Cost
- Sustainability Implications
- Connections to outdoor learning environments
- Safety & Security
- Parking Considerations
- Swing Space Considerations

# Prime differentiators

- Site utilization & building footprint
- Building height
- Salvage of 1938 façade
- Attempt to save mature oak tree
- Entrance & Identity
- Access to public use spaces (gym, cafetorium, etc.)
- Impact on central library
- Rooftop Solar PV quantity

# Concept Plans

## *Additions & Renovations*



## *New Construction*

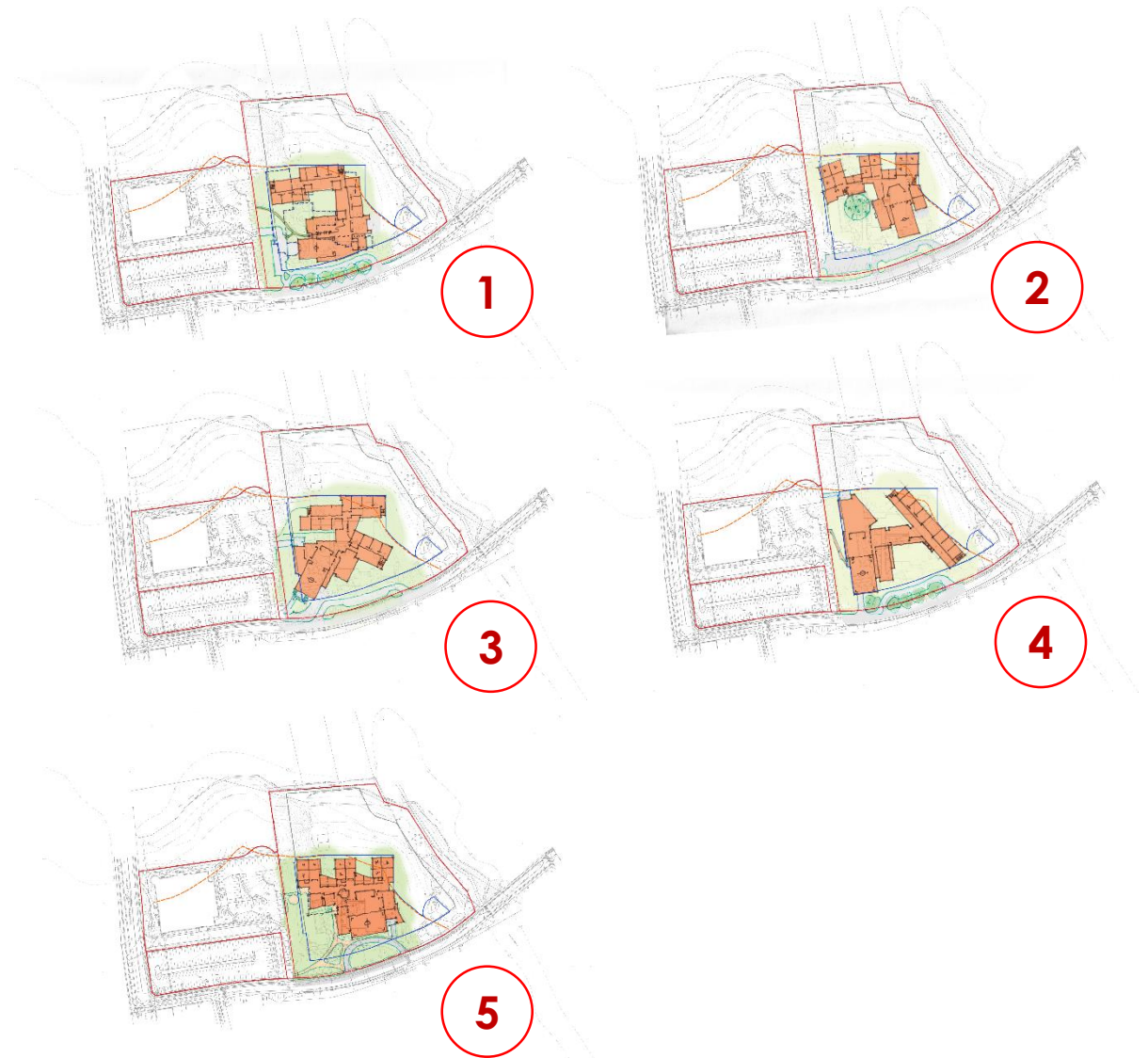



# Concept Plans

## *Additions & Renovations*

## *New Construction*

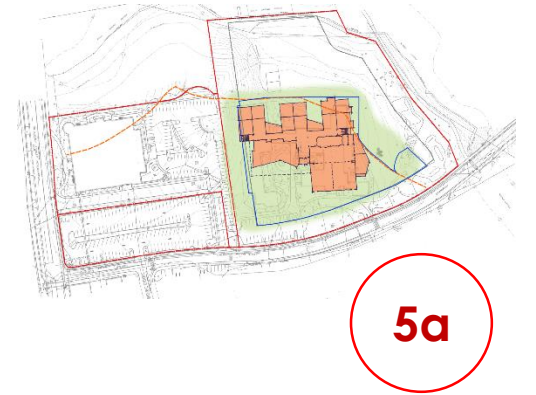

# Thoughts on Shortlisting – “Characteristics”:

## (2) Additions and Renovation Options

- Save only most valued (front) portion of 1938 Building
  - (1) two-story option (no variances required)
  - (1) three story option (height variance required)
  - One option shall attempt to preserve the oak tree
- (2) variations on Classroom Neighborhood Configuration(s)
- Core Educational Environment (quiet side of site)
- Community Uses & Access Options
- Main Entrance (Identity)
- Service Entrance Location

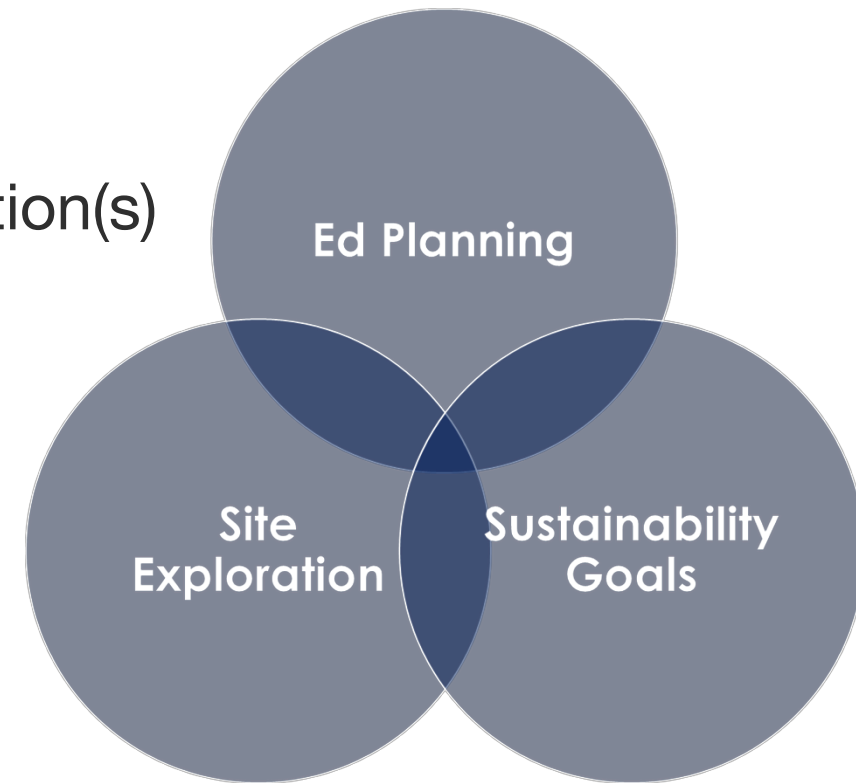

# Additions & Renovations: Recommendations



Option 4a



Option 5

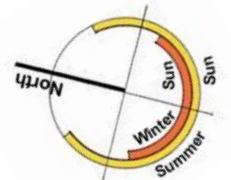



# Additions & Renovations

## Option 4a – Further Analysis

### Pros:

- Two/three story (TBD)
- Building massing
- Improved loading location
- Classroom orientation
- Maintains front of 1938 building
- Community Space Access
- Access to play zones
- Builds “As of Right” (TBD)

### Cons:

- Removes Oak Tree

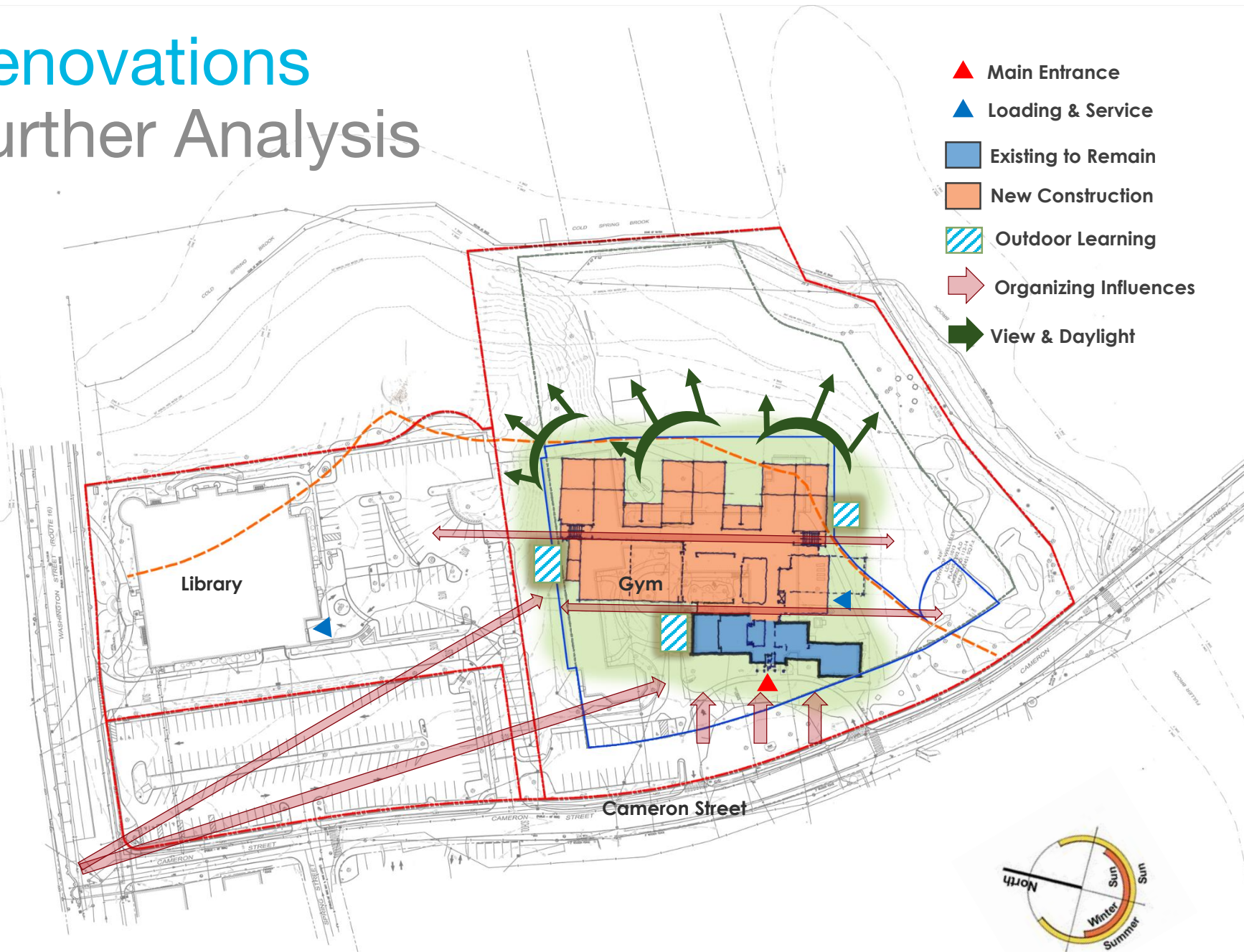

# Additions & Renovations

## Option 4a – Further Analysis

### Pros:

- Two/three story (TBD)
- Building massing
- Improved loading location
- Classroom orientation
- Maintains front of 1938 building
- Community Space Access
- Access to play zones
- Builds “As of Right” (TBD)

### Cons:

- Removes Oak Tree

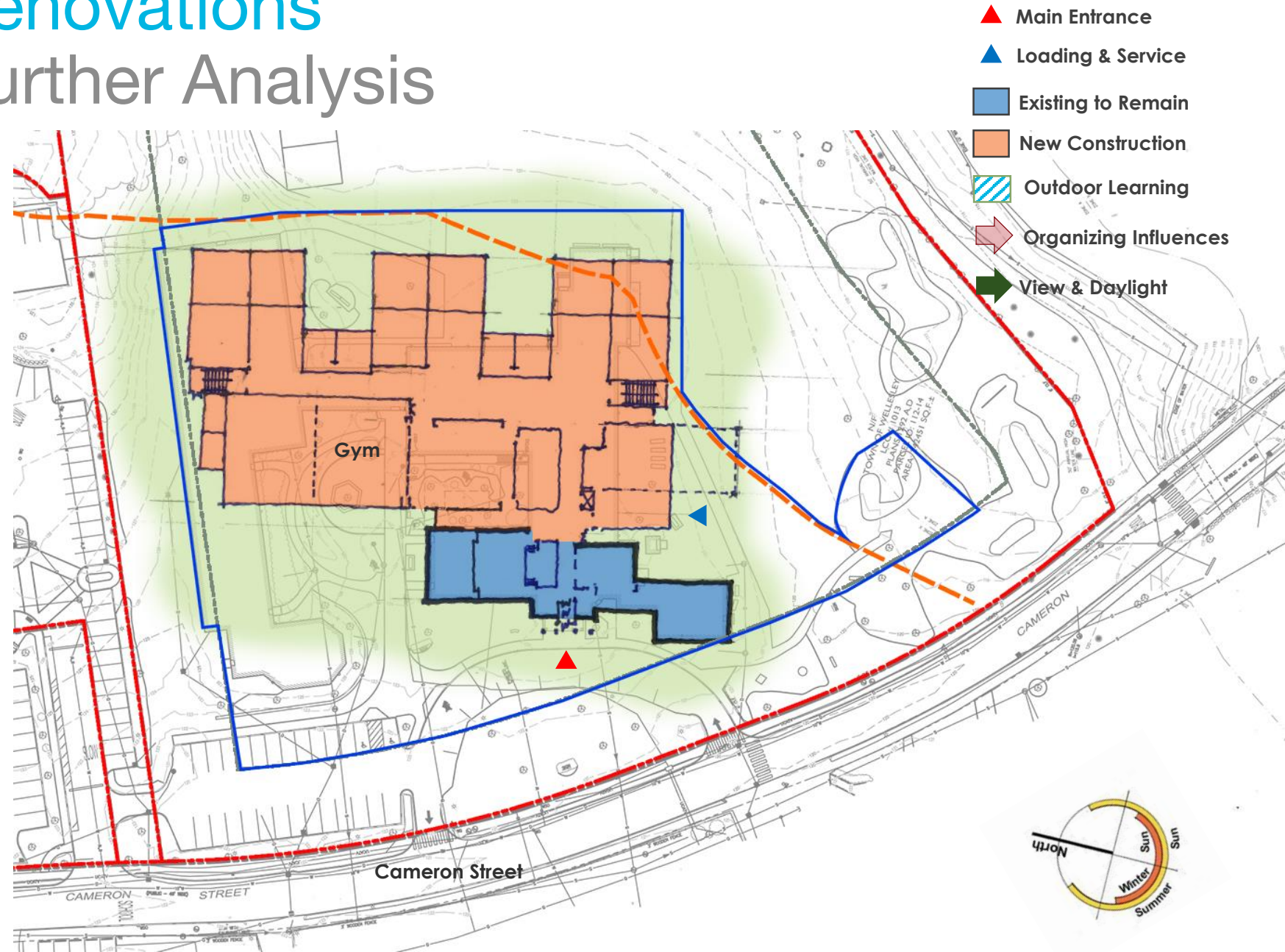



# Additions & Renovations

## Option 5 – New Considerations

### Pros:

- Maintains Oak Tree (aesthetics – survivability TBD)
- Building massing
- Improved loading location
- Classroom orientation
- Maintains front of 1938 building
- Access to play zones
- Compact footprint

### Cons:

- Three Story
- Community space access
- Requires set back relief

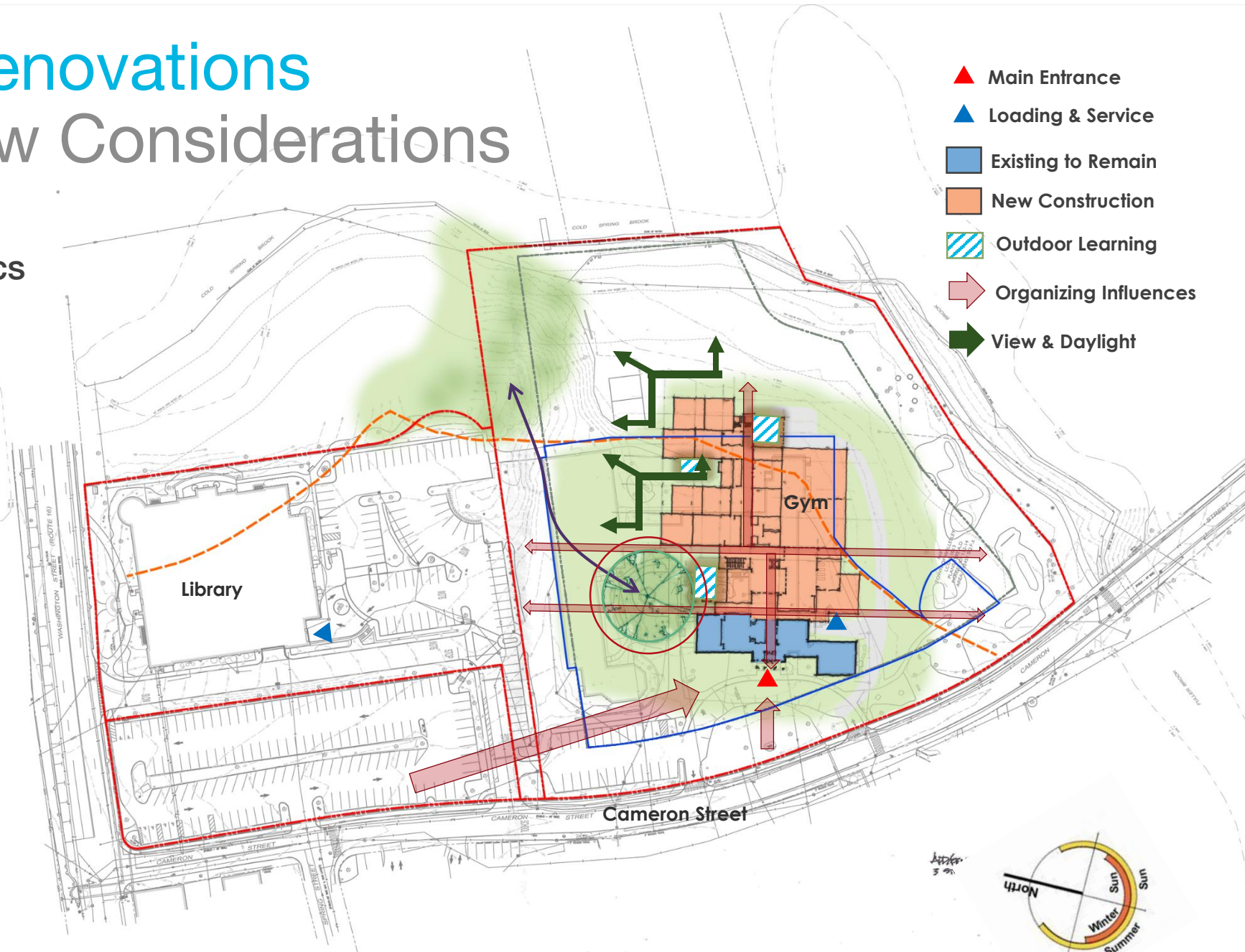



# Additions & Renovations

## Option 5 – New Considerations

### Pros:

- Maintains Oak Tree (aesthetics – survivability TBD)
- Building massing
- Improved loading location
- Classroom orientation
- Maintains front of 1938 building
- Access to play zones

### Cons:

- Three Story
- Community space access
- Requires set back relief



# Thoughts on Shortlisting – “Characteristics”:

## (2) All New Construction Options

- (2) variations on Classroom Neighborhood Configuration(s)
- (1) two story option (no variances required)
- (1) three story option (height variance required)
- One option shall attempt to preserve the oak tree
- Core Educational Environment (quiet side of site)
- Community Uses & Access Options
- Main Entrance (Identity)
- Service Entrance





# New Construction: Recommendations

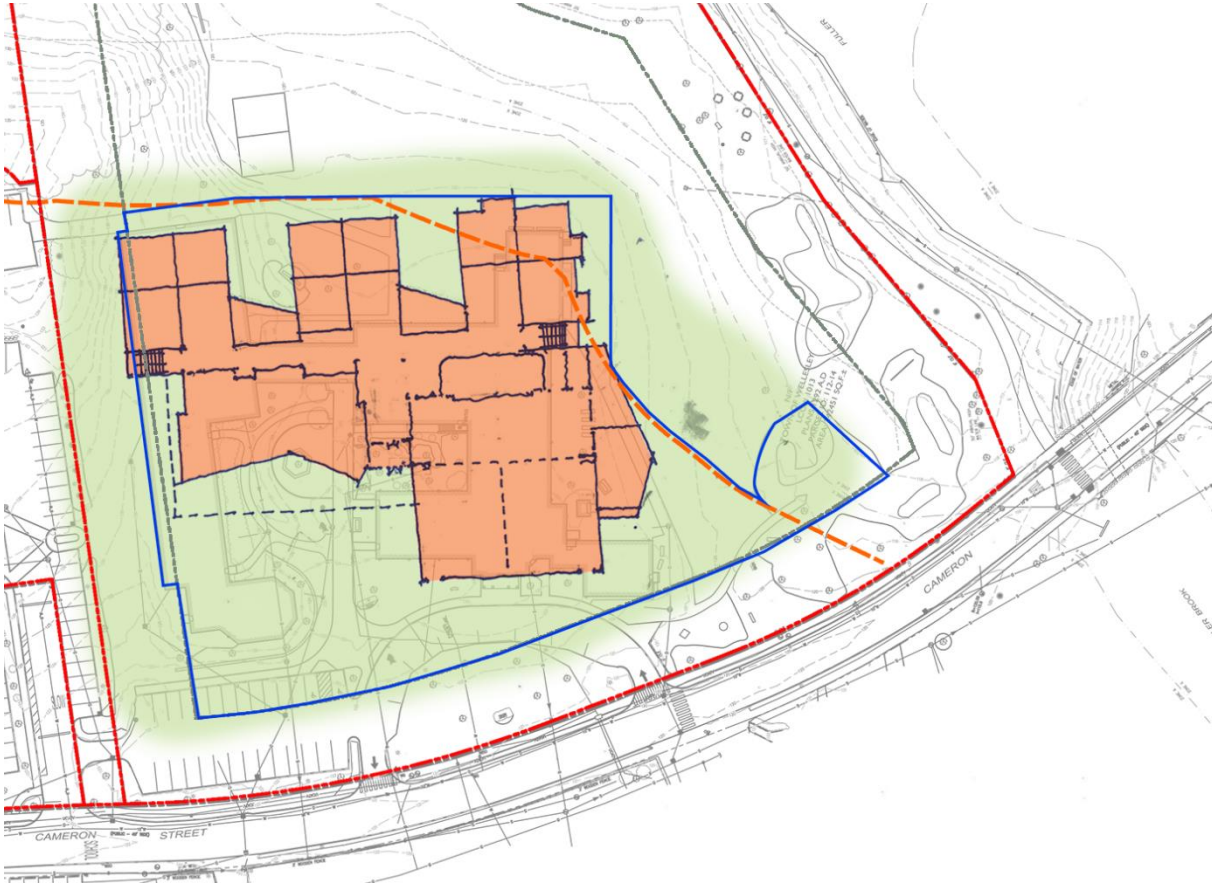

Option 5a

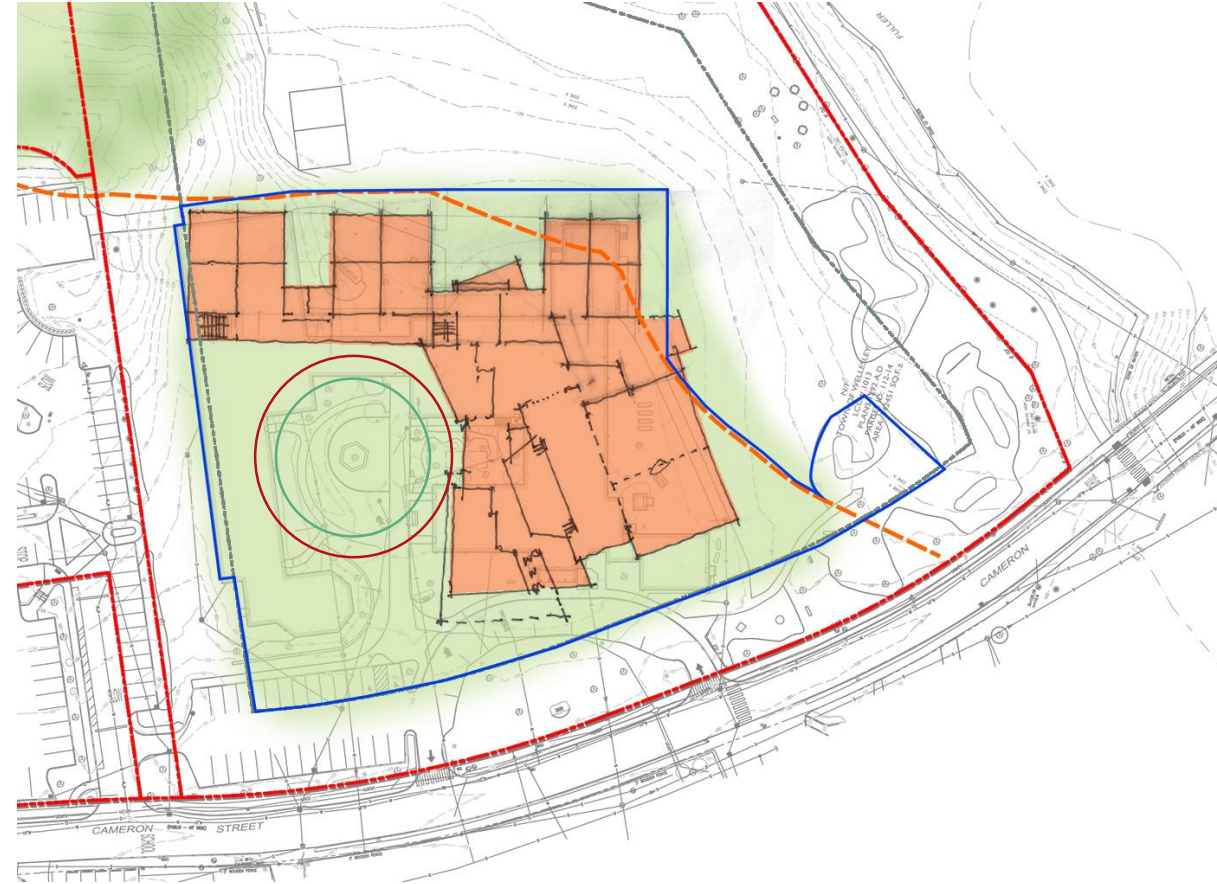

Option 6

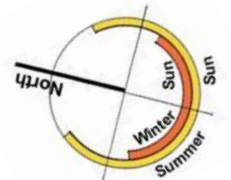



# New Construction

## Option 5a – Further Analysis

### Pros:

- Staff Favorability
- Compact footprint
- Classroom orientation
- Two story (TBD)
- Specialists' spaces connected to public space & classrooms
- Community Space Access
- Loading area location

### Cons:

- Massing of gym at front
- Removes Oak Tree
- Removes 1938 Building

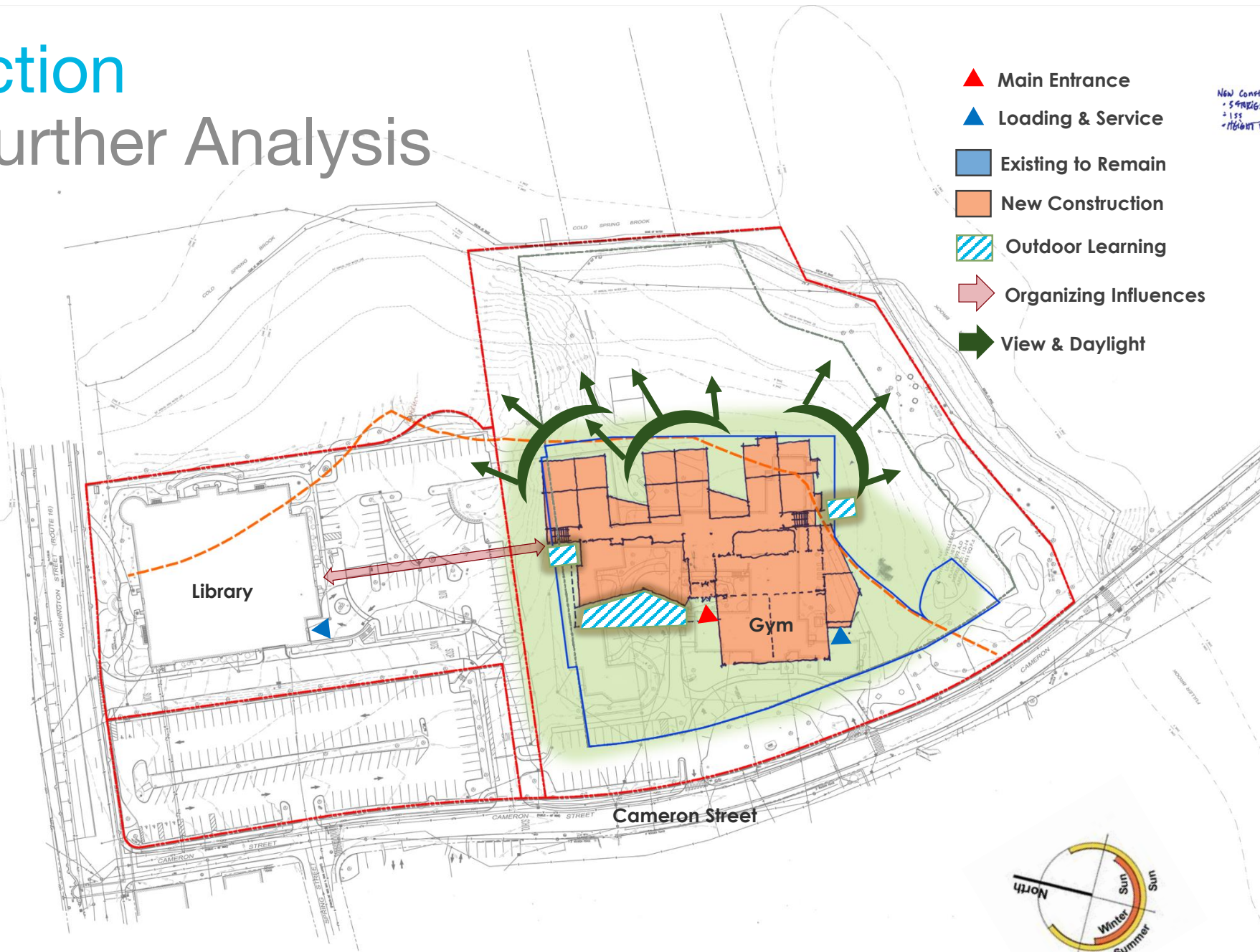

# New Construction

## Option 5a – Further Analysis

### Pros:

- Efficient footprint
- Classroom orientation
- Two story (TBD)
- Specialists' spaces connected to public space & classrooms
- Community Space Access
- Loading area location

### Cons:

- Massing of gym at front
- Removes Oak Tree
- Removes 1938 Building

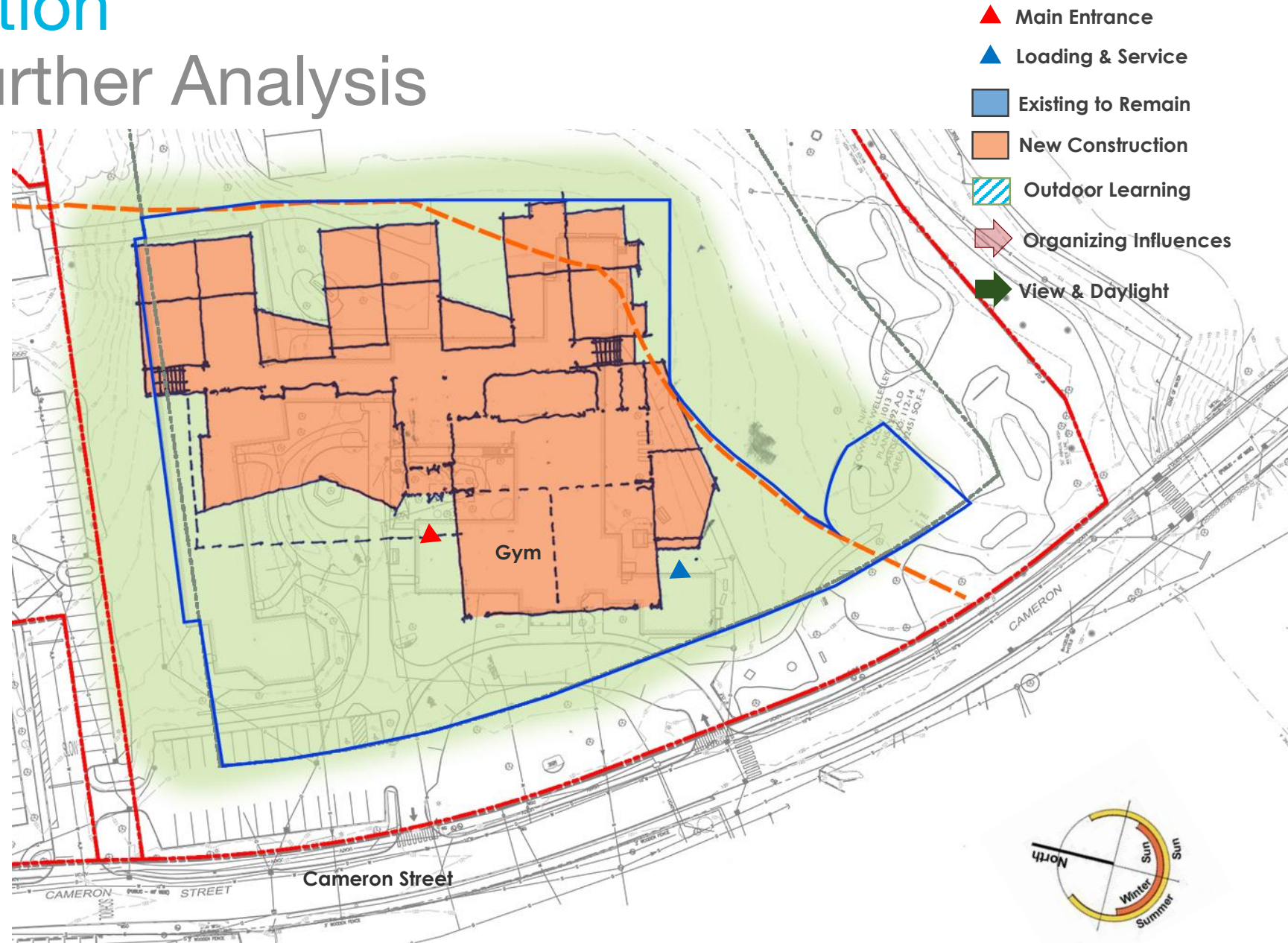



# New Construction

## Option 6 – New Considerations

### Pros:

- Two Story
- Classroom orientation
- Improved Massing of gym at front
- Specialists' spaces connected to public space & classrooms
- Community Space Access

### Cons:

- Loading area location (deeper in the site)
- Removes 1938 Building
- Removes Oak Tree (TBD)





# Option 6 – New Considerations

### Pros:

- Two Story
- Classroom orientation
- Improved Massing of gym at front
- Specialists' spaces connected to public space & classrooms
- Community Space Access

## Cons:

- Loading area location (deeper in the site)
- Removes 1938 Building
- Removes Oak Tree

