



**Town of Wellesley
Planning Department**
Lower Level - Town Hall
525 Washington Street
Wellesley, MA
781-431-1019 x2232

Historic Preservation Demolition Review APPLICATION FOR ELIGIBILITY NOTICE

Pursuant to Article 46C of the Town Bylaws, **submission of this application (SIDE 1) to the Planning Department and issuance of an Eligibility Notice is required before a permit to demolish (or remove or envelope more than 50%) will be issued by the Building Department for a building or structure used as a dwelling within the last 3 years;** if the dwelling is determined to have been built on or prior to December 31, 1949, a Preservation Determination (SIDE 2) must be made by the Historical Commission (and any imposed Delay Period shall have expired or been waived) before issuance of a permit to demolish (or remove or envelope more than 50%).

Application Information:

Property Address: 3 CHESTERTON RD.

What year was the structure built? 1937 Source of information: GTS

Check One: Full/Complete Demolition Partial Demolition/Envelopment (50% or more)

Please Attach the Following Required Information:

- Assessor's map showing property location
- Photocopies of Assessors Record, Building Permit(s), and any other documentation to support construction date
- If a partial demolition or envelopment (50% or more), plans or drawings showing such partial demolition or envelopment.

Property Owner Name: ERIK C. ROCKWOOD Phone: 774-306-1194

Mailing Address: 3 CHESTERTON RD. Wellesley, MA 02481

Email Address: erik@rockwoodinc.com

Application Authorization:

Signature of Property Owner: E C Rockwood Date: 1/13/22

For Town Use Only

Submission Date: _____ Received By: _____

Fee Paid: \$ _____ Case Number: DR _____

Determination (refer to issued Eligibility Notice):

Not an Eligible Building Date Issued: _____

Eligible Building* Expiration Date: _____

*A Preservation Determination is required; please see **SIDE 2**

[Print This Page](#)

Parcel Information:

Location: 3 Chesterton Rd
Parcel ID: 180-117--
Class: 101 1-Family
Type: Residential
Lot Size: 10,118
Census: 0
Zoning: SR10-Single Residence
Survey #: 0

Assessed Values

2022 Market Value	
Land	\$656,000
Building	\$255,000
Other	\$1,000
Total	\$912,000

Assessment History

Year	Total Value
2022	\$912,000
2021	\$912,000
2020	\$912,000
2019	\$912,000
2018	\$854,000
2017	\$855,000
2016	\$838,000
2015	\$838,000
2014	\$761,000
2013	\$691,000
2012	\$691,000
2011	\$668,000

Owner Information

Name: Wilson-Byrne, Martha &
 Rockwood, Erik C

Address: 3 Chesterton Road
 Wellesley, MA 02481

Notes:

Building Information

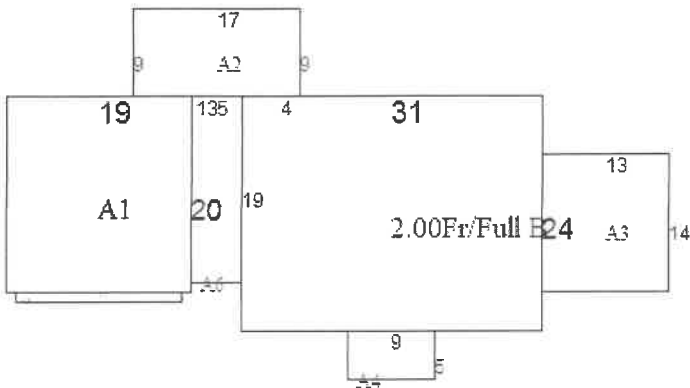

Frame	Wood	Basement	Full
Style	Colonial	Heating	Basic
Stories	2.00	Heat Sys	Warm Air
Ext Walls	Alum/Vinyl	Fuel Type	Gas
Rooms	7	Attic	None
Beds	4	Condition	Average
Full Bath	2	Grade	B
Half Bath	1	Traffic	L5
Extra Fix		Fireplaces	2
Rec Room	11 x20		
Fin Bsmt	none	Year Built	1937
Bsmt Gar	none	Year Remod	
Stacks	0	TLA	1,865

Area	Lower	First	Second	Third	Area
Main					744
A1	Frame Garage		1/2s Frame		380
A2	Wood Deck				153
A3	Encl. Frame Porch				182
A4	1s Frame				45
A5	Frame Garage				17
A6	1s Frame		1/2s Frame		95

Other Improvements

Code	Type	Qty	Year	Length	Width	Grade	Condition	Adj
1	Patio - Concrete	1	1980	1	100	C	Fair	1

per data inspection 2011 "fin over garage for family rm-un heated; first flr half bath newer; kitchen original, hardwd flrs in DR, LR w/tp; 2 full baths on 2nd flr are original"

Notes:

Wellesley Property Viewer



1/12/2022, 9:07:30 PM

Assessor Parcels

