

# 201901491



Town of Wellesley  
Planning Department  
Lower Level - Town Hall  
525 Washington Street  
Wellesley, MA  
781-431-1019 x2232

Historic Preservation  
Demolition Review  
APPLICATION FOR  
ELIGIBILITY NOTICE

Rec'd  
\$850.00  
CR# 1154

Pursuant to Article 46C of the Town Bylaws, submission of this application (SIDE 1) to the Planning Department and issuance of an Eligibility Notice is required before a permit to demolish (or remove or envelope more than 50%) will be issued by the Building Department for a building or structure used as a dwelling within the last 3 years; if the dwelling is determined to have been built on or prior to December 31, 1949, a Preservation Determination (SIDE 2) must be made by the Historical Commission (and any imposed Delay Period shall have expired or been waived) before issuance of a permit to demolish (or remove or envelope more than 50%).

**Application Information:**

Property Address: 60 OAK STREET

What year was the structure built? 1940 Source of information: BLDG PERMIT

Check One:  Full/Complete Demolition  Partial Demolition/Envelopment (50% or more)

Please Attach the Following Required Information:

- Assessor's map showing property location
- Photocopies of Assessors Record, Building Permit(s), and any other documentation to support construction date
- If a partial demolition or envelopment (50% or more), plans or drawings showing such partial demolition or envelopment.

Property Owner Name: KANE BUILT, INC Phone: 781-235-1461

Mailing Address: PO Box 620-636, NEWTON, MA 02462

Email Address: KANE@KANE'BUILTHOMES.COM

**Application Authorization:**

Signature of Property Owner: [Signature] Date: 5.19.22

**For Town Use Only**

Submission Date: 5/20/22 Received By: \_\_\_\_\_

Fee Paid: \$ 850.00 Case Number: DR 2022-26

**Determination (refer to issued Eligibility Notice):**

Not an Eligible Building Date Issued: \_\_\_\_\_

Eligible Building\* Expiration Date: \_\_\_\_\_

\*A Preservation Determination is required; please see **SIDE 2**

SIDE 1

## Application for Preservation Determination

Based on the Eligibility Notice issued for the subject property noted on **Side 1** of this form, pursuant to Article 46C of the Town Bylaws, a Preservation Determination must be made by the Historical Commission (and any imposed Delay Period shall have expired or been waived) before issuance of a permit to demolish (or remove or envelope more than 50%).

### Application Authorization:

As Owner of the subject property identified on Side 1 of this form, the structure(s) located thereon determined to be an Eligible Building, I am requesting that the Wellesley Historical Commission make a Preservation Determination for the applicable structure(s); if I am making this request at the same time that I am seeking an Eligibility Notice, I am acknowledging that the structure is an Eligible Building and waiving my right to appeal such a determination:

Property Owner Name: KANE BUILT, INC

Signature of Property Owner: [Signature] Date: 5.19.22

### Documentation Requirements:

Please submit the following additional information for consideration by the Historical Commission, as applicable:

- **In the case of partial demolition**, plans showing the use or development of the site after such demolition, if known, and a statement identifying all zoning variances and/or special permits which may be required in order to implement the proposed use or development, if known; and
- **In the case of ANY demolition**, photographs of all existing façade elevations of the Building

For Town Use Only	
Documentation Submission Date: _____	Received By: _____
Fee Paid: \$ _____	WHC Public Hearing Date: _____
<b>Historical Commission Determination (refer to issued Notice of Preservation Determination):</b>	
<input type="checkbox"/> Not Preferably Preserved	Date Issued: _____
<input type="checkbox"/> Preferably Preserved	Expiration of Delay Period (if applicable): _____

### Request to Reduce Delay Period (Waiver)\*

\*May not be sought until a Preservation Determination is made by the Historical Commission

As Owner of the subject property identified on Side 1 of this form, the structure(s) located thereon determined to be an Eligible Building and Determined to be Preferably Preserved, I am requesting that the Wellesley Historical Commission make a determination as to whether or not to reduce or modify the Delay Period.

Property Owner Name: \_\_\_\_\_

Signature of Property Owner: \_\_\_\_\_ Date: \_\_\_\_\_

**To accompany this request, the Owner should submit documentation evidencing any attempts to sell the property or plans and elevations for proposed construction to follow any Demolition.**

Date..... March 28, 1940.....

Street..... Oak Street ..... No. .... 60 ..... Precinct..... 3 ..... Permit No. .... 7091 .....

Owner Frank Villa Address 53 Leary Road

Architect same Address same

Builder Patsy Nicolai Address 13 Pine Tree Road

Permit Granted 3/28/40 Area of Lot 70x70x200

Dimensions 32x32x26 Est. Cost \$ 4,300.00

Date of Inspections PLANS ON FILE

Date of Inspections

Plumbing, No. of Baths, etc. #3027

Heating Hot Water

Remarks Dwelling

Date..... March 28, 1940 .....

Street..... Oak Street..... No. .... 60 ..... Precinct..... 3 ..... Permit No. .... 7092 .....

Owner Frank Villa Address 53 Leary Road

Architect P.P. Address

Builder Patsy Nicolai Address 13 Pine Tree Road

Permit Granted 3/28/40 Area of Lot 70x70x200

Dimensions Est. Cost \$ 200.00

Date of Inspections PLANS ON FILE

Date of Inspections

Plumbing, No. of Baths, etc.

Heating

Remarks Garage in Basement

# Wellesley Property Viewer

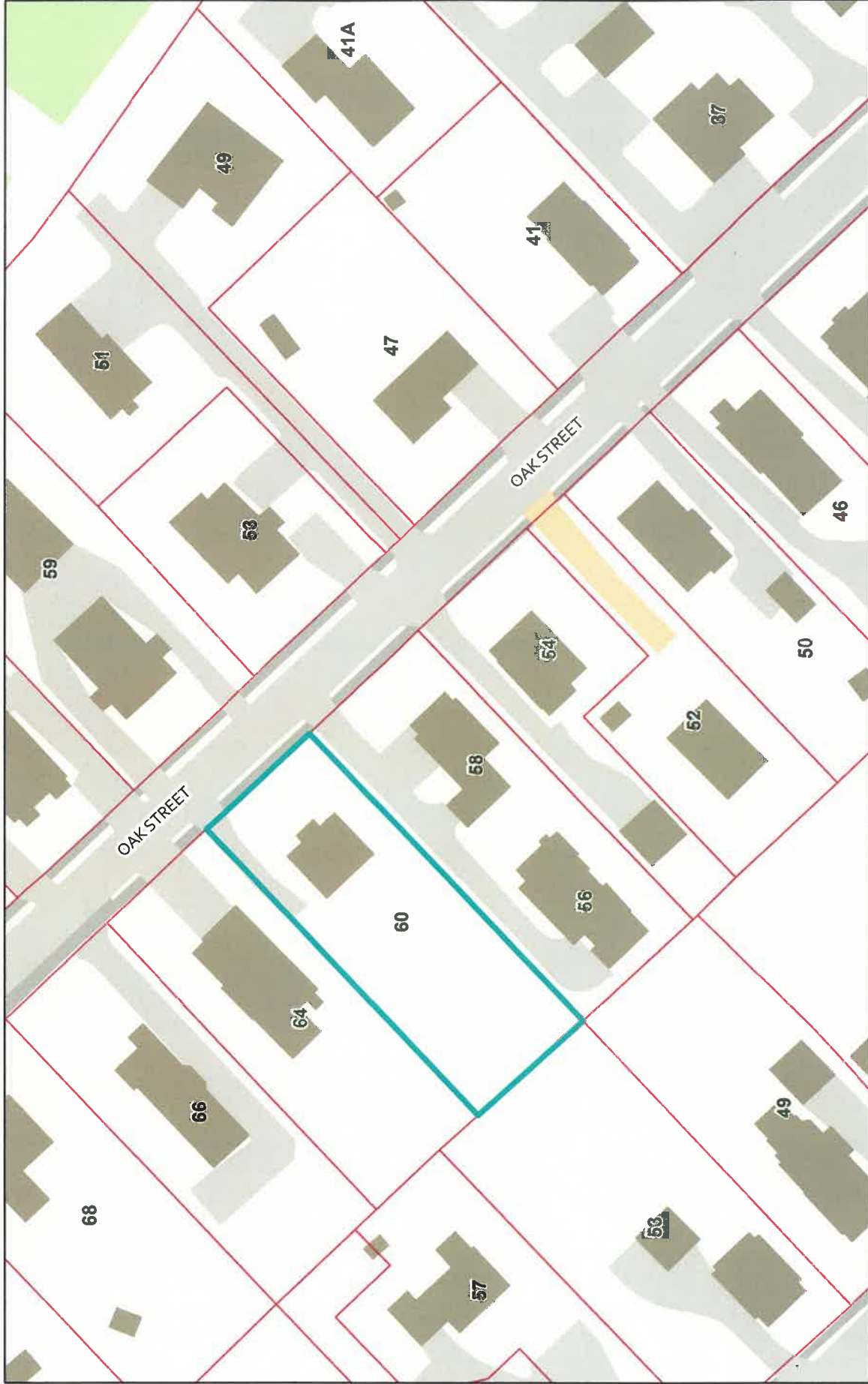

5/18/2022, 10:07:21 AM

Assessor Parcels

1:1,128

