

Print This Page

Parcel Information:

Location: [14 Alba Rd](#)
 Parcel ID: 98-48- -
 Class: 101 1-Family
 Type: Residential
 Lot Size: 11,588
 Census: 0
 Zoning: SR10-Single Residence
 Survey #: 0

| | 2022 Market Value |
|--------------|-------------------|
| Land | \$704,000 |
| Building | \$248,000 |
| Other | \$3,000 |
| Total | \$955,000 |

Assessment History

| Year | Total Value |
|------|-------------|
| 2022 | \$955,000 |
| 2021 | \$925,000 |
| 2020 | \$925,000 |
| 2019 | \$816,000 |
| 2018 | \$744,000 |
| 2017 | \$745,000 |
| 2016 | \$730,000 |
| 2015 | \$702,000 |
| 2014 | \$634,000 |
| 2013 | \$582,000 |
| 2012 | \$582,000 |
| 2011 | \$545,000 |

Owner Information

Name: Su, Xiaojing &
 Yin, Xiliang

Address: 14 Alba Road
 Wellesley, MA 02481

Notes:

Building Information

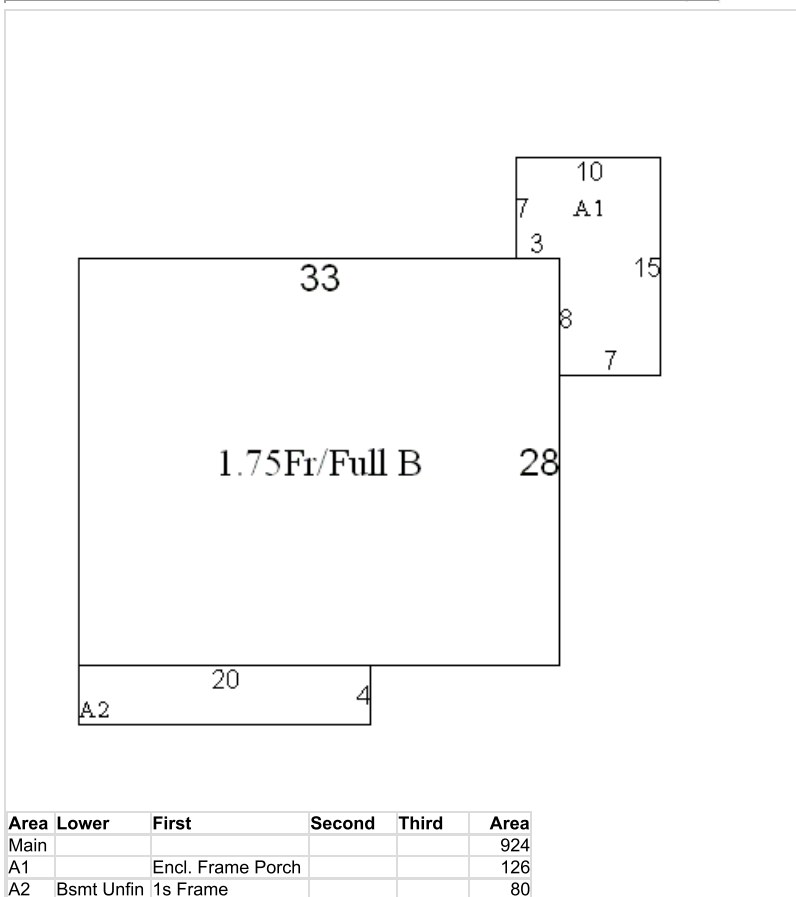

| | | | |
|-----------|----------|------------|-------------|
| Frame | Wood | Basement | Full |
| Style | Cape Cod | Heating | Central Air |
| Stories | 1.75 | Heat Sys | Hot Water |
| Ext Walls | Frame | Fuel Type | Oil |
| Rooms | 6 | Attic | None |
| Beds | 2 | Condition | Average |
| Full Bath | 1 | Grade | B+ |
| Half Bath | 1 | Traffic | L5 |
| Extra Fix | | Fireplaces | 1 |
| Rec Room | none | | |
| Fin Bsmt | none | Year Built | 1948 |
| Bsmt Gar | 1 stalls | Year Remod | |
| Stacks | 0 | TLA | 1,697 |

Other Improvements

| Code | Type | Qty | Year | Length | Width | Grade | Condition | Adj |
|------|--------------------|-----|------|--------|-------|-------|-----------|-----|
| 1 | Patio - Stone/Tile | 1 | 2010 | 20 | 15 | C | Average | 1 |

Per'18 MLS"great fir pln;expansion potential;hrdwd thru out;oversized LR-fp;EIK;3 season screen sunporch;priv.bckyrd;DR-bl-t-in cabinet;1st fir Bdrm/Den;2nd fir Mstr Bdrm-w/i clst;2015-17-new patio,shingles,insulation,storm windows,trim & gutters"

Notes:

Land Description

| Topography | Utilities | Street | Paved | Landlocked | No | View | Average |
|--------------|------------|--------|--------|------------|-----|-------------|---------|
| Above Street | Public Gas | Road | Public | Sidewalk | Yes | Landscaping | |
| | | | | Gas | Yes | | |

Market

| Type | Description | Zone | Nhbd | Area | Infl | Traffic |
|------|--------------|-----------------------|------|-------|------|---------|
| 1 | Primary Site | SR10-Single Residence | 301 | 11588 | 1 | L5 |

Sales Information

| Date | Price | Vol | Page | Seller | Valid Code |
|-----------|-------------|-----|--------|-------------------|-----------------------------|
| 5/30/2018 | \$1,050,000 | LC | 198141 | Haviland, Susan K | V. sale of multiple parcels |
| 11/8/2002 | \$0 | LC | 138782 | Regan, Susan | N. other |

Print This Page