

Parcel Information:

[Print This Page](#)

Assessment History

**Location:** [76 Washington St.](#)  
**Parcel ID:** 43-68- -  
**Class:** 101 1-Family  
**Type:** Residential  
**Lot Size:** 13,042  
**Census:** 0  
**Zoning:** SR10-Single Residence  
**Survey #:** 0

2022 Market Value	
Land	\$649,000
Building	\$369,000
Other	\$0
<b>Total</b>	<b>\$1,018,000</b>

Year	Total Value
2022	\$1,018,000
2021	\$933,000
2020	\$933,000
2019	\$872,000
2018	\$873,000
2017	\$864,000
2016	\$832,000
2015	\$833,000
2014	\$778,000
2013	\$737,000
2012	\$737,000
2011	\$730,000

Owner Information

**Name:** Locke, Jeffrey A & Joanne M

**Address:** 76 Washington Street Wellesley, MA 02481

**Notes:** Garage is located on sep. parcel (43-75)

Building Information

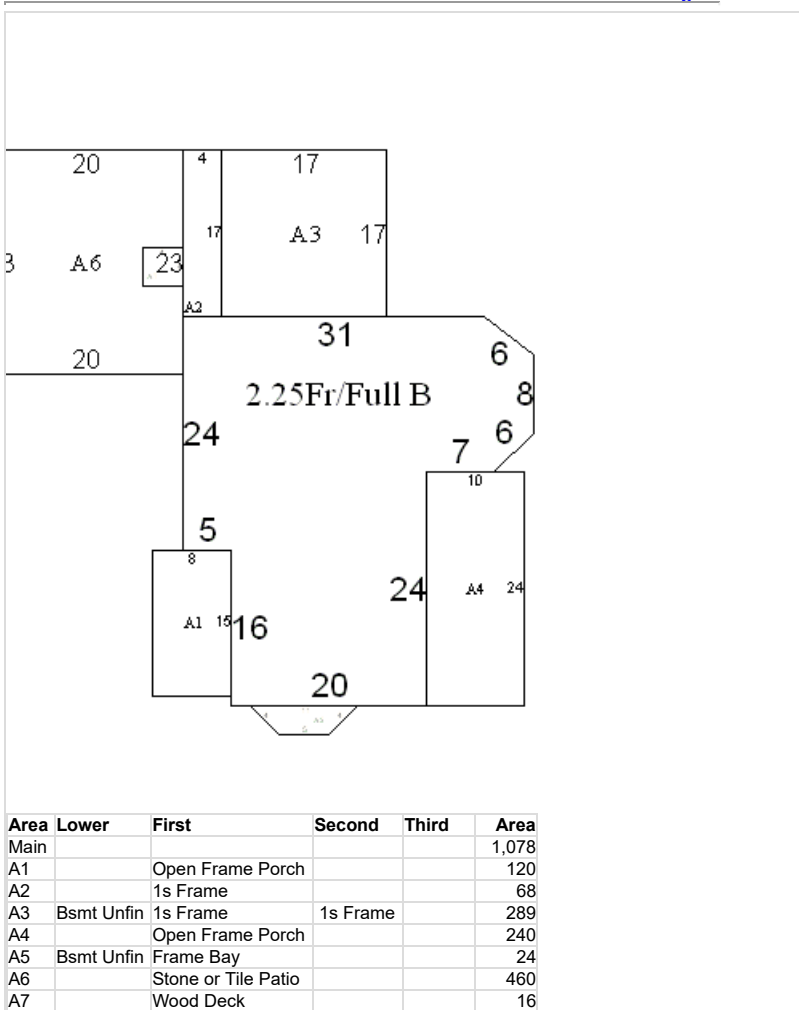

Frame	Wood	Basement	Full
Style	Colonial	Heating	Basic
Stories	2.25	Heat Sys	Hot Water
Ext Walls	Frame	Fuel Type	Gas
Rooms	10	Attic	None
Beds	4	Condition	Above Average
Full Bath	2	Grade	A-
Half Bath	1	Traffic	E5
Extra Fix		Fireplaces	1
Rec Room	none		
Fin Bsmt	none	Year Built	1873
Bsmt Gar	none	Year Remod	
Stacks	0	TLA	3,096

Other Improvements

Code	Type	Qty	Year	Length	Width	Grade	Condition	Adj
						none		

Garage is on separate parcel, 31 Crescent St. (43-75)

Notes:

Land Description

Topography	Utilities	Street	Paved	Landlocked	No	View	Average
Above Street	Public Gas	Road	Public	Sidewalk	Yes	Landscaping	
				Gas	Yes		

