



Massachusetts Department of Environmental Protection
Bureau of Resource Protection - Wetlands
WPA Form 4B - Order of Resource Area Delineation
Massachusetts Wetlands Protection Act M.G.L. c. 131 S40

Provided by MassDEP:
MassDEP File #:324-0779
eDEP Transaction #:750529
City/Town:WELLESLEY

A. General Information

1. Conservation Commission WELLESLEY

2. This Issuance is for (Check one):

- a. Order of Resource Area Delineation
b. Amended Order of Resource Area Delineation

3. Applicant Details

a. First Name PETER b. Last Name CRABTREE
c. Organization NORTHLAND RESIDENTIAL CORPORATION
d. Mailing Address 20 MALL ROAD
e. City/Town BURLINGTON f. State MA g. ZIP 01803

4. Property Owner (if different from applicant):

a. First Name PETER b. Last Name CRABTREE
c. Organization NORTHLAND RESIDENTIAL CORPORATION
d. Mailing Address 20 MALL ROAD
e. City/Town BURLINGTON f. State MA g. ZIP 01803

5. Project Location

a. Street Address 135 GREAT PLAIN AVENUE
b. City/Town WELLESLEY c. Zip 02482
d. Assessors Map/Plat# 68 e. Parcel/Lot# 1
f. Latitude 42.29167N g. Longitude 71.27389W

6. Dates

a. Date ANRAD Filed 4/6/2015 b. Date Public Hearing Closed 6/4/2015 c. Date Of Issuance 6/15/2015

7. Final Approved Plans and Other Documents

Plan Title	Plan Prepared By	Plan Signed By	Plan Final Date	Plan Scale
SEE ATTACHED "EXHIBIT A" FOR LIST OF PLANS AND OTHER DOCUMENTS				

B. Order of Delineation

1. The Conservation Commission has determined the following (check whichever is applicable)

a. **Accurate:** The boundaries described on the referenced plan(s) above and in the Abbreviated Notice of Resource Area Delineation are accurately drawn for the following resource area(s):

1. Bordering Vegetated Wetlands
2. Other resource area(s), specifically
a.

b. **Modified:** The boundaries described on the plan(s) referenced above, as modified by the Conservation Commission from the plans contained in the Abbreviated Notice of Resource Area Delineation, are accurately drawn from the following resource area(s):

1. Bordering Vegetated Wetlands
2. Other resource area(s), specifically
a. RIVERFRONT AREA, LAND UNDER WATER BODIES AND WATERWAYS, BANK, BORDERING LAND



Massachusetts Department of Environmental Protection
Bureau of Resource Protection - Wetlands

**WPA Form 4B – Order of Resource Area
Delineation**

Massachusetts Wetlands Protection Act M.G.L. c. 131, §40

Provided by MassDEP:
324- 0779
MassDEP File Number
750529
eDEP Transaction Number
Wellesley
City/Town

E. Signatures

6/16/15
Date of Issuance

Please indicate the number of members who will sign this form.

5
1. Number of Signers

[Signature] Robert Collins

[Signature] Carl Sciple

[Signature] J. Stanley Waugh

[Signature] Richard Howell

[Signature] Neal Glick

This Order is valid for three years from the date of issuance.

If this Order constitutes an Amended Order of Resource Area Delineation, this Order the issuance date of the original Final Order, which expires on _____ unless extended in writing by the issuing authority.

This Order is issued to the applicant and the property owner (if different) as follows:

2. By hand delivery on _____

a. Date

3. By certified mail, return receipt requested on _____

a. Date

6/17/18

[Symbol]	BORDERING VEGETATED WETLAND (B/W)
[Symbol]	TOP OF BANK
[Symbol]	25' NO DISTURBANCE ZONE (BYLAW)
[Symbol]	100' BUFFER ZONE
[Symbol]	200' RIVERFRONT AREA WETLANDS PROTECTION ACT
[Symbol]	LANDS WITHIN 200' OF RIVER (BYLAW)
[Symbol]	200' RIVERFRONT AREA WETLANDS PROTECTION ACT AND LANDS WITHIN 200' OF RIVER (BYLAW)
[Symbol]	BORDERING LAND SUBJECT TO FLOODING (FEA ZONE A)
[Symbol]	PROPERTY LINE
[Symbol]	25' NO DISTURBANCE ZONE (BYLAW)

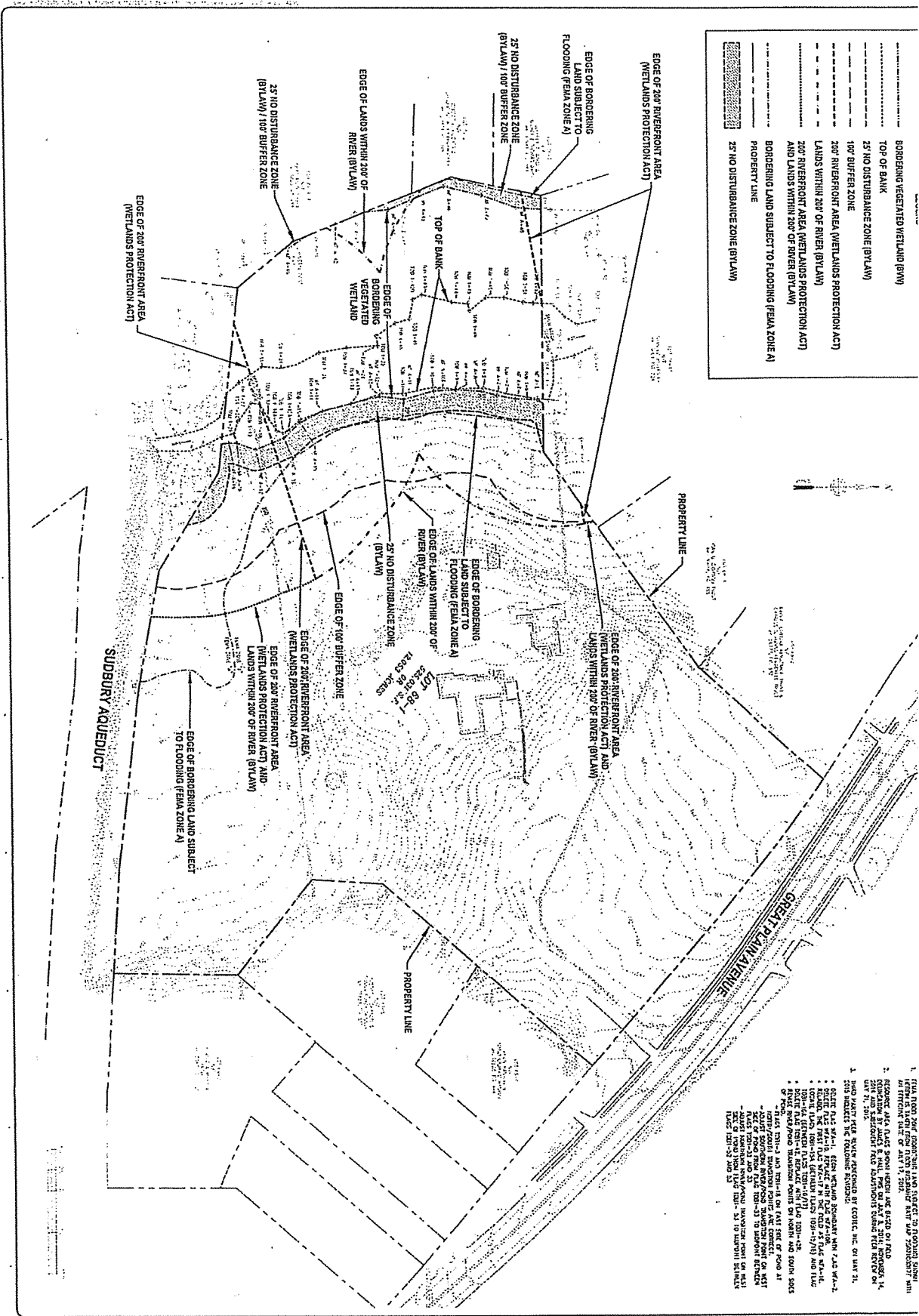

1. FINAL PLAN SHALL BE SUBJECT TO A FLOODING STUDY BY THE CITY OF WELLESLEY.
2. RECORDING MAPS SHALL BE SUBJECT TO THE CITY OF WELLESLEY RECORDING DEPARTMENT AND THE CITY OF WELLESLEY RECORDING DEPARTMENT SHALL BE REQUIRED TO RECORD THE MAPS.
3. THIS PLAN SHALL BE SUBJECT TO THE CITY OF WELLESLEY RECORDING DEPARTMENT AND THE CITY OF WELLESLEY RECORDING DEPARTMENT SHALL BE REQUIRED TO RECORD THE MAPS.
4. THIS PLAN SHALL BE SUBJECT TO THE CITY OF WELLESLEY RECORDING DEPARTMENT AND THE CITY OF WELLESLEY RECORDING DEPARTMENT SHALL BE REQUIRED TO RECORD THE MAPS.
5. THIS PLAN SHALL BE SUBJECT TO THE CITY OF WELLESLEY RECORDING DEPARTMENT AND THE CITY OF WELLESLEY RECORDING DEPARTMENT SHALL BE REQUIRED TO RECORD THE MAPS.
6. THIS PLAN SHALL BE SUBJECT TO THE CITY OF WELLESLEY RECORDING DEPARTMENT AND THE CITY OF WELLESLEY RECORDING DEPARTMENT SHALL BE REQUIRED TO RECORD THE MAPS.
7. THIS PLAN SHALL BE SUBJECT TO THE CITY OF WELLESLEY RECORDING DEPARTMENT AND THE CITY OF WELLESLEY RECORDING DEPARTMENT SHALL BE REQUIRED TO RECORD THE MAPS.
8. THIS PLAN SHALL BE SUBJECT TO THE CITY OF WELLESLEY RECORDING DEPARTMENT AND THE CITY OF WELLESLEY RECORDING DEPARTMENT SHALL BE REQUIRED TO RECORD THE MAPS.
9. THIS PLAN SHALL BE SUBJECT TO THE CITY OF WELLESLEY RECORDING DEPARTMENT AND THE CITY OF WELLESLEY RECORDING DEPARTMENT SHALL BE REQUIRED TO RECORD THE MAPS.
10. THIS PLAN SHALL BE SUBJECT TO THE CITY OF WELLESLEY RECORDING DEPARTMENT AND THE CITY OF WELLESLEY RECORDING DEPARTMENT SHALL BE REQUIRED TO RECORD THE MAPS.

RA-001	135 GREAT PLAIN AVENUE WELLESLEY, MASSACHUSETTS	<p>131 Essex Street Wellesley, MA 02458 Tel: 781.235.8200</p>		<p>Residential Corporation</p>		<table border="1"> <tr> <th>No.</th> <th>Revised</th> <th>By</th> <th>For</th> </tr> <tr> <td>1</td> <td></td> <td></td> <td></td> </tr> <tr> <td>2</td> <td></td> <td></td> <td></td> </tr> <tr> <td>3</td> <td></td> <td></td> <td></td> </tr> <tr> <td>4</td> <td></td> <td></td> <td></td> </tr> </table>	No.	Revised	By	For	1				2				3				4			
	No.					Revised	By	For																		
1																										
2																										
3																										
4																										
New Date: 03/25/13 Project No: 22218 Scale: 1" = 50' Date: 03/25/13 Drawn: JPL Check: JPL	RESOURCE AREA PLAN	Only: JPL Date: JPL Check: JPL	2/14/13	2/14/13																						

